



**1 Jefferson Plaza, London, E3**

**BUTLER & STAG**





## Impressive one bedroom apartment set on the 20th floor of a modern development rich in resident amenities and positioned right next to Bromley-by-Bow underground station.



- One Bedroom Modern Apartment
- South-Facing Private Balcony
- Next to Bromley-by-Bow Station
- Unfurnished
- 20th Floor with Stunning Views
- 24-Hour Concierge and Gym Access
- Supermarkets Nearby
- Flexibly Available from 1st October

Featuring a spacious open-plan reception room with a fully integrated contemporary kitchen, a south-facing private balcony with quite simply stunning views offers a glorious extension to the living/entertaining space. Further comprising of a bright double bedroom with fitted wardrobes, a contemporary bathroom and a hallway storage cupboard.

Marner Point is a sought-after and secure development that boasts 24-hour concierge service, a residents-only gym and a large communal roof terrace with 360-degree views across the London skyline.

Located on the doorstep of Bromley-by-Bow tube station and close to Devons Road DLR, swift and direct access to Canary Wharf and The City was never easier. Westfield Shopping Centre is close by, as are the open green spaces of Victoria Park and the Olympic Village.

Offered unfurnished and flexibly available from 1st October 2025.

EPC Rating B  
Council Tax Band C







## Marner Point E3

Approx. Gross Internal Area 43 Sq M ( 463 Sq Ft)

BUTLER & STAG

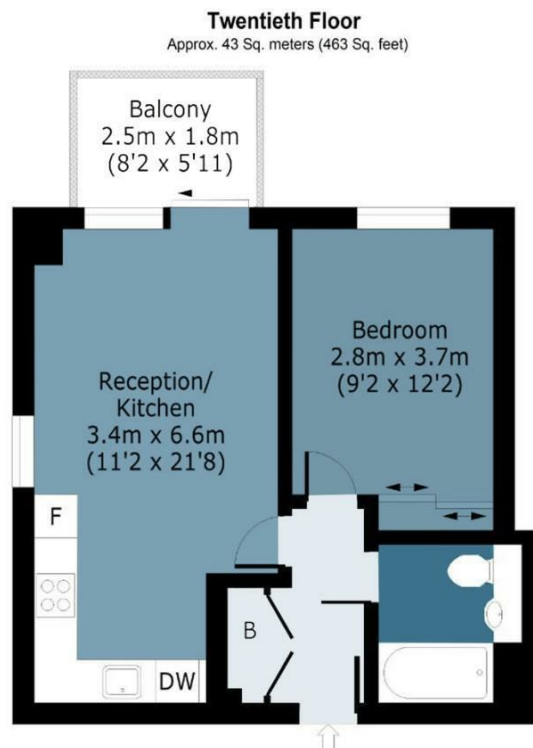

Measurements are approximate and for illustration purposes only. While we do not doubt the accuracy and completeness, we advise you conduct a careful independent assessment of the property to determine monetary value.  
© @modephoto.uk www.modephoto.co.uk

IMPORTANT NOTICE - These particulars have been prepared in good faith and they are not intended to constitute part of an offer or contract. We have not performed a structural survey on this property and the services, appliances and specific fittings have not been tested. All photographs, measurements, floor plans and distances referred to are given as a guide and should not be relied upon.

BUTLER & STAG

☎ 020 8102 1236

🏠 508 Roman Road, Bow, London, E3 5LU

✉ bow@butlerandstag.com

[www.butlerandstag.uk](http://www.butlerandstag.uk)